

Injection System - Parts

Neptune Diaphragm PZ31 pump: Part #'s 2701, 2702

Key No.	Part No.	Description
1	PZ-101299	Anti-siphon check valve
2	PZ-101301	Foot valve assembly
3	PZ-107247	Discharge valve assembly
4	PZ-107248	Suction valve assembly
5	PZ-107251	Air release valve assembly
6	PZ-107252	Pump head
<input checked="" type="checkbox"/>	PZ-107258	Diaphragm set
<input checked="" type="checkbox"/>	PZ-107262	Valve seat sets (pkg. of 2)
<input checked="" type="checkbox"/>	PZ-107567	Retaining ring
7	PZ-107568	Coupling hose nut
<input checked="" type="checkbox"/>	PZ-107976	Complete repair kit
8	PZ-10342-16	Discharge tubing, black, .375 OD (16ft.)
9	PZ-10469-06	Suction tubing, clear, .375 OD (6ft.)
10	PZ-120994	Air release valve tubing .2500

= Not Illustrated

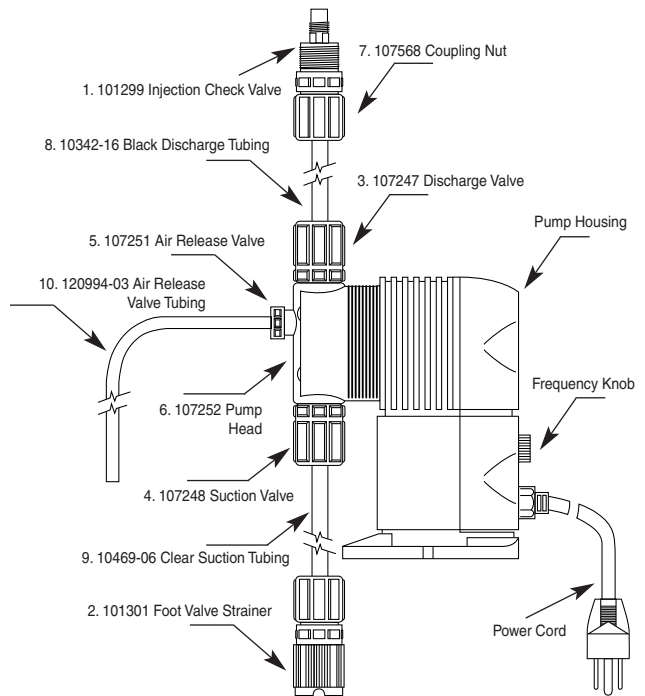

Stenner Peristaltic pump: Part #'s 2678, 2688, 2692

Key No.	Part No.	Description
1	S-UCAK100	Connecting nut 1/4" (pkg of 10)
2	S-UCAK200	Ferrule 1/4" (pkg of 10)
3	S-ST114	Suction line strainer 1/4"
4	S-AK4002B	Discharge/suction tube 1/4"
<input checked="" type="checkbox"/>	S-AK4010B	Discharge/suction tube 1/4"
5	S-UCDBINJ	Injection check valve 1/4"
<input checked="" type="checkbox"/>	S-UCCVDBO	Check valve (duck bill type) (pkg of 2)
<input checked="" type="checkbox"/>	S-UCCP201	# 1 Tube assembly with ends (pkg of 2)(85MHP5)
<input checked="" type="checkbox"/>	S-UCCP202	#2 Tube assembly with ends (pkg of 2)(45MHP10)
<input checked="" type="checkbox"/>	S-UCCP207	# 7 Tube assembly with ends (pkg of 2)(45MHP22)
<input checked="" type="checkbox"/>	S-HPACK-1B	1/4" Accessory kit with #1 tube assembly for 85MHP5
<input checked="" type="checkbox"/>	S-HPACK-2B	1/4" Accessory kit with #2 tube assembly for 45MHP10
<input checked="" type="checkbox"/>	S-HPACK-7B	1/4" Accessory kit with #7 tube assembly for 45MHP22
6	S-MP1000	Rain Roof
<input checked="" type="checkbox"/>	S-UCTHC1D	#1 Tube head assembly
<input checked="" type="checkbox"/>	S-UCTHC2D	#2 Tube head assembly
<input checked="" type="checkbox"/>	S-FC504OD	Feed rate controller

= Not Illustrated

